

MODE 3.1

Retro Bracket Kit

This Kit includes:

- 1 retro bracket
- 4 mounting screws

BKT14331

INSTALLATION

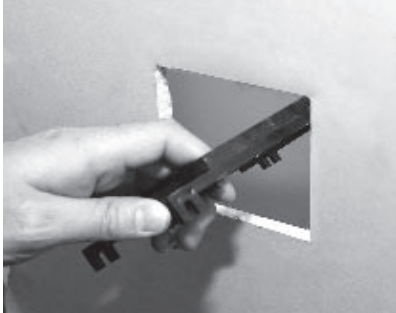

1. Cut drywall hole to 3 5/8" x W 3 7/8". Then place bracket through the opening with the FRONT/TOP on the left side as shown.

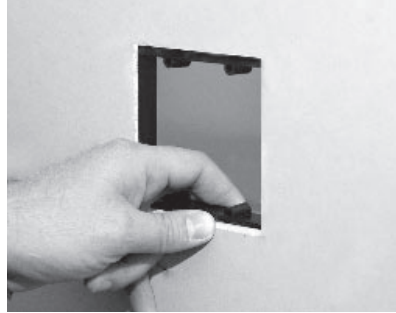

2. Pull the bracket back towards the drywall, make sure bracket flushes to back of drywall.

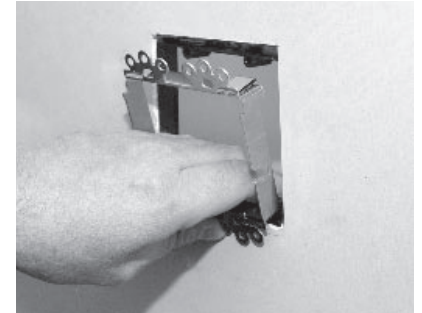

3. While holding the main retro bracket, add the MODE 3.1 bracket.

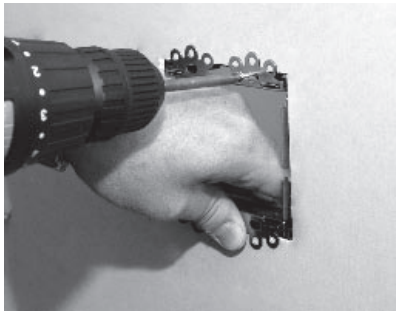

4. While holding both brackets, Attached the MODE 3.1 bracket to the main retro bracket using the mounting screws provided.

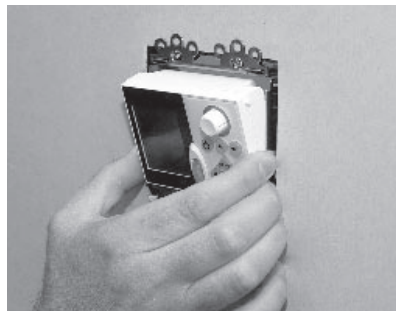

5. The two brackets will sandwich the drywall between them, thus providing a sturdy mounting system for the MODE 3.1

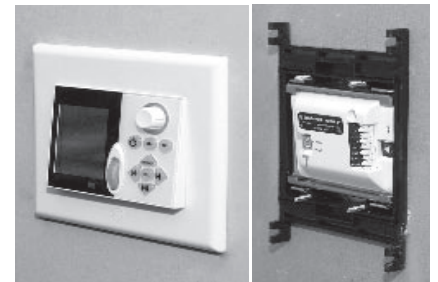

6. Finished product. Front and Rear view shown above.

SPECIFICATIONS

Cut-Out Size: 3 5/8" x 3 7/8" **(Note: Make sure to make the hole cut-out to be as tight as possible to insure a good fit.)**

LIMITED LIFETIME WARRANTY

Defective products must be shipped, together with proof of purchase, prepaid insured to the SpeakerCraft Authorized Dealer from whom they were purchased, or to the SpeakerCraft factory at the address listed on this installation instruction manual. Freight collect shipments will be refused. It is preferable to ship this product in the original shipping container to lessen the chance of transit damage. In any case, the risk or loss or damage in transit is to be borne by the purchaser. If upon examination at the Factory or SpeakerCraft Authorized Dealer it is determined that the unit was defective in materials or workmanship at any time during this warranty period, SpeakerCraft or the SpeakerCraft Authorized Dealer will, at its option, repair or replace this product at no additional charge, except as set forth below. If this model is no longer available and can not be repaired effectively, SpeakerCraft, at its sole option may replace the unit with a current model of equal or greater value. In some cases where a new model is substituted, a modification to the mounting surface may be required. If mounting surface modification is required, SpeakerCraft assumes no responsibility or liability for such modification. All replaced parts and product become the property of SpeakerCraft Inc. Products replaced or repaired under this warranty will be returned to the original retail purchaser, within a reasonable time, freight prepaid.

This warranty does not include service or parts to repair damage caused by accident, disaster, misuse, abuse, negligence, inadequate packing or shipping procedures, commercial use, voltage inputs in excess of the rated maximum of the unit, or service, repair or modification of the product which has not been authorized or approved by SpeakerCraft. This warranty also excludes normal cosmetic deterioration caused by environmental conditions. This warranty will be void if the Serial number on the product has been removed, tampered with or defaced.

This warranty is in lieu of all other expressed warranties. If the product is defective in materials or workmanship as warranted above, the purchaser's sole remedy shall be repair or replacement as provided above. In no event will SpeakerCraft be liable for any incidental or consequential damages arising out of the use or inability to use the product, even if SpeakerCraft Inc. or a SpeakerCraft Inc. Authorized Dealer has been advised of the possibility of such damages, or for any claim by any other party. Some states do not allow the exclusion or limitation of consequential damages, so the above limitation and exclusion may not apply.

All implied warranties on the product are limited to the duration of this expressed warranty. Some states do not allow limitation on the length of an implied Warranty. If the original retail purchaser resides in such a state, this limitation does not apply.

If you have any questions regarding this or any other SpeakerCraft product, please contact your local Authorized SpeakerCraft dealer, or you may contact SpeakerCraft toll-free at 1-800-448-0976 for immediate customer assistance. We are available to assist you every weekday, except holidays, between the hours of 7:00 a.m. and 5:00 p.m.

SpeakerCraft®